

# FOR LEASE 7000 Airways Park Dr.

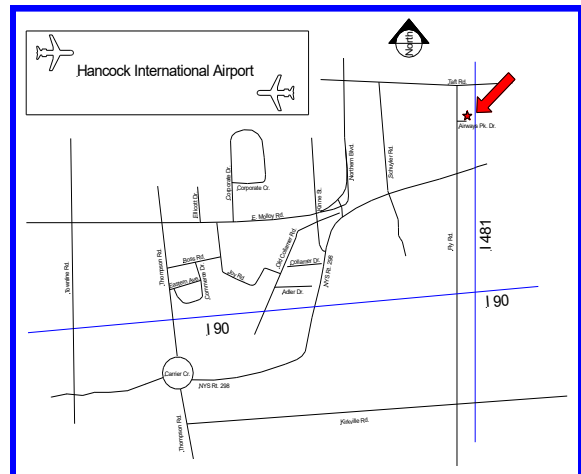

- **3,520 SF of Office and Warehouse Space**
- **12'x10' Dock Door**
- **12' Ceiling Height in Warehouse**
- **End Space with Lots of Glass**

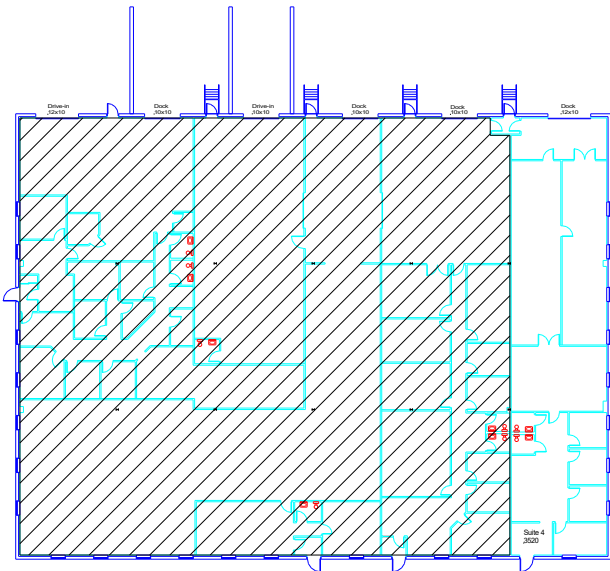

6724 Thompson Road • Syracuse, NY 13211

For more info contact:  
Ed Rogers  
Phone: 315-463-8684  
Cell: 315-427-8510  
E-mail: [Ed@olivaco.com](mailto:Ed@olivaco.com)  
[www.olivaco.com](http://www.olivaco.com)

*All information is believed to be accurate. We are not responsible for misstatements of facts, errors or omissions, prior sales, and changes of price or withdrawal from the market without notice.*