

# FOR SALE OR LEASE Medical & Office Spaces

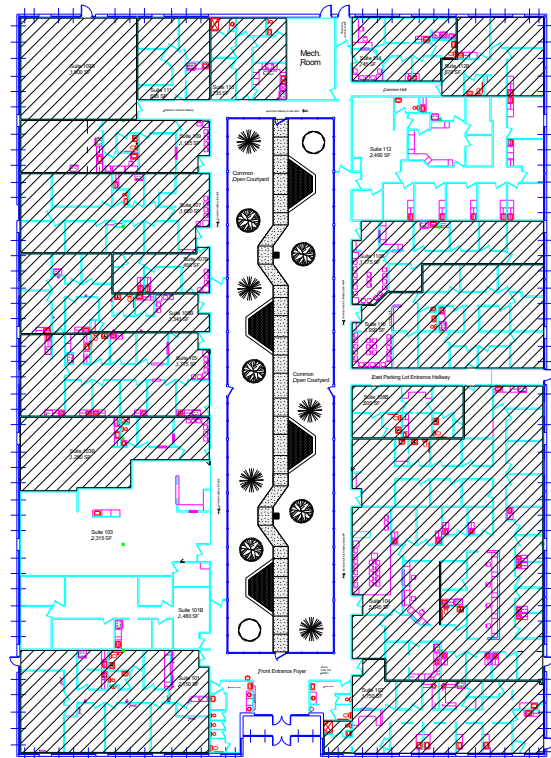

## Cicero Professional Building 6221 Route 31, Cicero

- 36,000 SF Medical & Office Spaces for Lease from 1,480 to 3,795 SF of Contiguous Space
- Convenient Location On Route 31 and Near Interstate 81
- 6,000 SF Interior Landscaped Courtyard with Benches
- Additional Rear Parking to be Added
- Fully Built-Out Medical Suites
- All Utilities and CAM included
- Prices Start at \$16.00 for Office Spaces and \$19.50 for Medical Spaces
- Sale Price: \$3.5 Million



6724 Thompson Road • Syracuse, NY 13211

For more info contact:  
Ed Rogers  
Phone: 315-463-8684  
Cell: 315-427-8510  
E-mail: [Ed@olivaco.com](mailto:Ed@olivaco.com)  
[www.olivaco.com](http://www.olivaco.com)

*All information is believed to be accurate. We are not responsible for misstatements of facts, errors or omissions, prior sales, and changes of price or withdrawal from the market without notice.*